



399 Elmhurst Street
Hayward, CA 94544-1307
(510) 670-5480

March 30, 2012

Subject: Upcoming Construction Activities on Flood Control Channel at Farwell Drive Crossing

This letter is to inform you that the Alameda County Flood Control and Water Conservation District (District) will be constructing improvements to increase channel flow conveyance at the Farwell Drive crossing, to meet FEMA's 100-year storm (one percent annual chance of occurring) design requirement. The improvements when completed will enable the District to apply to FEMA a Letter of Map Revision (LOMR) to remove the existing 100-year Special Flood Hazard zone designation. When FEMA approves the LOMR, the mandatory flood insurance purchase requirement will no longer apply. The following construction information is provided for reference:

Anticipated Construction Schedule

- ❖ Start date: April 9, 2012, weather permitting.
- ❖ Duration: April thru end of August 2012.
- ❖ Construction hours: 8:30 AM to 5:30 PM, Mondays thru Fridays. No work on weekends.

During Construction Hours

- ❖ No parking will be allowed on Farwell Drive for approximately 150 feet on both sides of the flood control channel, to provide adequate construction staging areas and vehicle movements.
- ❖ Half of the roadway will be closed off for construction work. Only one traffic lane will be available adjacent to the construction area. One lane traffic control will be in effect. The extent of traffic delay will depend on traffic volume. Blacow Road may be used as an alternate route to bypass construction area.
- ❖ All driveway access should be maintained; however, there may be delays depending on actual construction activities.
- ❖ Various size of construction equipment will be used to construct the necessary improvements.

After Construction Hours

- ❖ Construction equipment will be staged in designated areas on District property.
- ❖ Parking restrictions along curb side will not apply after 5:30 PM.

While the District continually strives to minimize construction impact to adjacent residents, we also recognize the likelihood of increased noise levels during construction operations due to construction machinery and activities.

The District would like to thank you in advance for your understanding and patience during construction of this flood control improvement. If you have any questions regarding this project, please feel free to call Manny Canivel at (510) 670-5775.

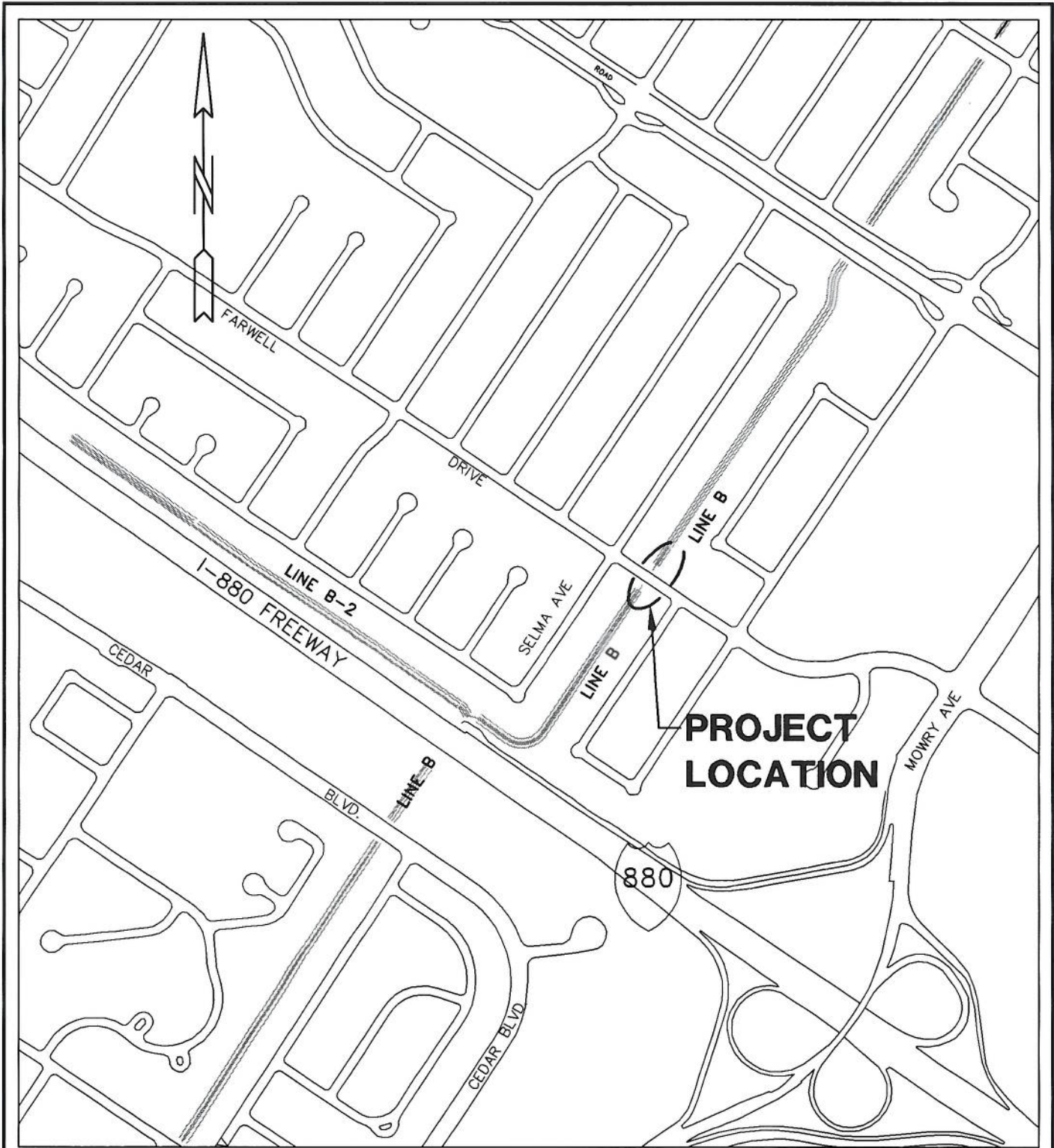

W.O. NO. F05C71

SPEC. NO. F 5-182

ALAMEDA COUNTY FLOOD CONTROL AND WATER CONSERVATION DISTRICT

**THE IMPROVEMENTS ALONG LINE B
AT FARWELL DRIVE CROSSING, IN FREMONT
ZONE NO. 5 PROJECT
LOCATION MAP**

\\Athena\Flood\CIP-Location Maps\Bord-Flood.dwg 11-29-01

DRAWN AB	CHECKED EC	DATE FEB 2011	SCALE NONE	FILE NO. CB-835	SHEET NO. L-1
-------------	---------------	------------------	---------------	--------------------	------------------